

PT2451 Digital Puller Tensioner - 100KN

GEN4.0 TECHNOLOGY



Features

- Used for overhead stringing - one rope or two conductors
- Machine completely electronically controlled with digital HMI
- Built in data recorder
- Hydraulic rope clamps
- Full radio remote operation with cord and
- HMI operation fail safes
- Two pairs of bull wheels with completely independent controls
- Bullwheels lined with high resistance interchangeable nylon sectors
- 2 negative self-acting hydraulic brakes
- Diesel engine - water cooled
- Rigid axle for towing at max speed of 30km/hr
- Hydraulic power pack to control up to 2 reel stands with hydraulic motor or tworeel winders with independent controls
- Synchronising mechanism
- Gearbox with 3 operating positions:
 - - Neutral position (with free bull-wheels for conductor loading and unloading).
 - - Low tension position: 2 ÷ 12 kN as tensioner & 0 ÷ 7 kN as puller
 - - Nominal tension position.
- Synchronising mechanism
- Hydraulic front stabiliser
- Grounding device on board
- Hydraulic oil cooling system
- Machine weight 6700kg

TESMEC



MAX TENSION
100kN



MAX SPEED
5km/h



CONDUCTOR DIAMETER
42mm

- ✓ Twin Bull Wheel for multiple conductors
- ✓ 9 GEN4.0 Technology
- ✓ 9 Ideal for overhead stringing

Performance	
Max pull/tension (kN)	2 x 50/ 1 x 100
Speed at max pull (km/hr)	2
Pull/tension at max speed (kN)	5
Max speed (km/hr)	5

Characteristics	
Engine Type	Diesel 105kW (140hp)
Engine Output (kW/hp)	105
Electrical System (V)	24
Bull wheel Dia. (mm)	1500
Max. conductor Dia. (mm)	42
Max. rope Dia. (mm)	21
Weight (kg)	6700

Ideal for stringing multiple conductors

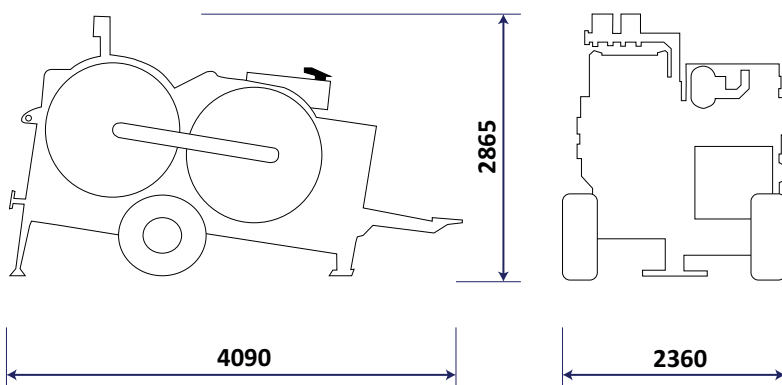

7" colour display



Radio remote control